



www.lakesandbridges.org

Lakes and Bridges Charter School's 2020-2021 School Re-Opening Plan

Contents

About the Re-Opening Committee/Task Force	3
Calendar Change	4
Re-Opening Scenarios	5
100% Virtual Learning	7
Class Schedules for 100% Virtual Learning and Distance/Hybrid Learning (Times to Sign On) ...	8
1st Grade	8
2nd Grade	8
3rd Grade	8
4th Grade (Ms. Maggie's class - the roster will be sent at a later date)	8
4th Grade (Mrs. Stoker's class - the roster will be sent at a later date)	9
5th Grade (Mrs. Rivers's Homeroom class - the roster will be sent at a later date)	9
5th Grade (Ms. Simmons's Homeroom class - the roster will be sent at a later date)	9
6th Grade (Ms. Compton's Homeroom class - the roster will be sent at a later date)	9
7th Grade (Mrs. Tucker's Homeroom class - the roster will be sent at a later date)	10
7th Grade (Mr. Duran's Homeroom class - the roster will be sent at a later date)	10
Arrival and Dismissal at School	10
Arrival	10
Dismissal	10
Classrooms	12
Classroom Supplies	12
Cleaning and Safety Plan	12
Dress Code	12
Facial Coverings	13
Health Information	13
Lunch	14
Physical Distancing	15
PE (Physical Education)	15
Recess	15
Safety Drills	15
Social/Emotional Learning	16
Technology Expectations	16
Water Bottles	17

About the Re-Opening Committee/Task Force

The Re-Opening Committee was formed in April in order to begin preparations for the 2020-2021 school year exploring different scenarios and the pros and cons of these scenarios. It consisted of the LABCS Leadership Team, which includes a parent. As we moved forward in the spring, the School Nurse and Office Manager joined the committee. When the AccelerateED committee recommended that school districts create a Task Force, the committee changed to a Task Force and brought in another parent. We have met at least twice a week for a minimum of two hours/meeting.

Surveys were sent to new families and returning families, and faculty and staff were asked how they felt being back in the building. The results of the surveys and faculty and staff feedback were taken into consideration for the re-opening plan. As of July 25, 2020, the school will start on August 17, in a hybrid model, and groups will be assigned as soon as we get the acceptance/declination forms returned. These forms will be sent out through a jotform link and will be due by Friday, July 31, indicating your choice for face-to-face, 100% Virtual Learning, or declining enrollment. Our hope is that by implementing a hybrid model, we will be able to stay face-to-face longer into the year before, when and/or if, we have to go to a distance model. We also view the hybrid model as an amazing opportunity for more intense and individualized face-to-face instruction.

Lakes and Bridges Charter School is following the ongoing situation with COVID-19 cases in Pickens County, Greenville County, and surrounding counties that reflect where our students come from, as well as the recommendations and guidelines set forth by the DHEC and SCDE and other sources to help determine the best scenario for re-opening school in the fall.

Please note that we know this is a fluid situation; as a result, this document will, likely, be a fluid document as well and that changes/amendments will probably be made from this re-opening plan.

As always, the highest priority is the safety, health, and well-being of the Lakes and Bridges Charter School community – teachers, support staff, independent contractors, students, and families.

In this together,

A handwritten signature in blue ink that reads "Heidi Bishop". The signature is written in a cursive, flowing style.

Heidi Bishop, Principal

Calendar Change

At this time, due to back orders on equipment and making sure our faculty is properly trained for virtual learning, the committee/Task Force recognizes that we need to push back the start of our calendar year by one week, from August 10 to August 17. Depending upon the risk level at the holidays, LABCS could go out at Thanksgiving Break for distance learning and return face-to-face on January 19, 2021. This calendar is subject to change as conditions change. The new calendar can be found [here](#).

Lakes and Bridges Charter School

2020-2021 Calendar

<p><u>10-14</u>—Teacher Workdays</p> <p><u>17</u>—First Day of School</p>	<p>AUGUST 2020</p> <table> <tr><th>S</th><th>M</th><th>T</th><th>W</th><th>T</th><th>F</th><th>S</th></tr> <tr><td></td><td></td><td></td><td></td><td></td><td></td><td>1</td></tr> <tr><td>2</td><td>3</td><td>4</td><td>5</td><td>6</td><td>7</td><td>8</td></tr> <tr><td>9</td><td>10</td><td>11</td><td>12</td><td>13</td><td>14</td><td>15</td></tr> <tr><td>16</td><td>17</td><td>18</td><td>19</td><td>20</td><td>21</td><td>22</td></tr> <tr><td>23</td><td>24</td><td>25</td><td>26</td><td>27</td><td>28</td><td>29</td></tr> <tr><td>30</td><td>31</td><td></td><td></td><td></td><td></td><td></td></tr> </table>	S	M	T	W	T	F	S							1	2	3	4	5	6	7	8	9	10	11	12	13	14	15	16	17	18	19	20	21	22	23	24	25	26	27	28	29	30	31						<p><u>15</u>—No School</p> <p><u>17</u>—Q3 Interim Report</p>	<p>FEBRUARY 2021</p> <table> <tr><th>S</th><th>M</th><th>T</th><th>W</th><th>T</th><th>F</th><th>S</th></tr> <tr><td></td><td>1</td><td>2</td><td>3</td><td>4</td><td>5</td><td>6</td></tr> <tr><td>7</td><td>8</td><td>9</td><td>10</td><td>11</td><td>12</td><td>13</td></tr> <tr><td>14</td><td>15</td><td>16</td><td>17</td><td>18</td><td>19</td><td>20</td></tr> <tr><td>21</td><td>22</td><td>23</td><td>24</td><td>25</td><td>26</td><td>27</td></tr> <tr><td>28</td><td></td><td></td><td></td><td></td><td></td><td></td></tr> </table>	S	M	T	W	T	F	S		1	2	3	4	5	6	7	8	9	10	11	12	13	14	15	16	17	18	19	20	21	22	23	24	25	26	27	28						
S	M	T	W	T	F	S																																																																																								
						1																																																																																								
2	3	4	5	6	7	8																																																																																								
9	10	11	12	13	14	15																																																																																								
16	17	18	19	20	21	22																																																																																								
23	24	25	26	27	28	29																																																																																								
30	31																																																																																													
S	M	T	W	T	F	S																																																																																								
	1	2	3	4	5	6																																																																																								
7	8	9	10	11	12	13																																																																																								
14	15	16	17	18	19	20																																																																																								
21	22	23	24	25	26	27																																																																																								
28																																																																																														
<p><u>7</u>—No School</p> <p><u>16</u>—Q1 Interim Report</p>	<p>SEPTEMBER 2020</p> <table> <tr><th>S</th><th>M</th><th>T</th><th>W</th><th>T</th><th>F</th><th>S</th></tr> <tr><td></td><td></td><td>1</td><td>2</td><td>3</td><td>4</td><td>5</td></tr> <tr><td>6</td><td>7</td><td>8</td><td>9</td><td>10</td><td>11</td><td>12</td></tr> <tr><td>13</td><td>14</td><td>15</td><td>16</td><td>17</td><td>18</td><td>19</td></tr> <tr><td>20</td><td>21</td><td>22</td><td>23</td><td>24</td><td>25</td><td>26</td></tr> <tr><td>27</td><td>28</td><td>29</td><td>30</td><td></td><td></td><td></td></tr> </table>	S	M	T	W	T	F	S			1	2	3	4	5	6	7	8	9	10	11	12	13	14	15	16	17	18	19	20	21	22	23	24	25	26	27	28	29	30				<p><u>18, 19</u>—No School</p> <p><u>23</u>—Q3 Ends</p> <p><u>30</u>—Q3 Report Card Sent Home</p>	<p>MARCH 2021</p> <table> <tr><th>S</th><th>M</th><th>T</th><th>W</th><th>T</th><th>F</th><th>S</th></tr> <tr><td></td><td>1</td><td>2</td><td>3</td><td>4</td><td>5</td><td>6</td></tr> <tr><td>7</td><td>8</td><td>9</td><td>10</td><td>11</td><td>12</td><td>13</td></tr> <tr><td>14</td><td>15</td><td>16</td><td>17</td><td>18</td><td>19</td><td>20</td></tr> <tr><td>21</td><td>22</td><td>23</td><td>24</td><td>25</td><td>26</td><td>27</td></tr> <tr><td>28</td><td>29</td><td>30</td><td>31</td><td></td><td></td><td></td></tr> </table>	S	M	T	W	T	F	S		1	2	3	4	5	6	7	8	9	10	11	12	13	14	15	16	17	18	19	20	21	22	23	24	25	26	27	28	29	30	31										
S	M	T	W	T	F	S																																																																																								
		1	2	3	4	5																																																																																								
6	7	8	9	10	11	12																																																																																								
13	14	15	16	17	18	19																																																																																								
20	21	22	23	24	25	26																																																																																								
27	28	29	30																																																																																											
S	M	T	W	T	F	S																																																																																								
	1	2	3	4	5	6																																																																																								
7	8	9	10	11	12	13																																																																																								
14	15	16	17	18	19	20																																																																																								
21	22	23	24	25	26	27																																																																																								
28	29	30	31																																																																																											
<p><u>19</u>—No School</p> <p><u>20</u>—Q1 Ends</p> <p><u>27</u>—Q1 Report Card Sent Home</p>	<p>OCTOBER 2020</p> <table> <tr><th>S</th><th>M</th><th>T</th><th>W</th><th>T</th><th>F</th><th>S</th></tr> <tr><td></td><td></td><td></td><td></td><td>1</td><td>2</td><td>3</td></tr> <tr><td>4</td><td>5</td><td>6</td><td>7</td><td>8</td><td>9</td><td>10</td></tr> <tr><td>11</td><td>12</td><td>13</td><td>14</td><td>15</td><td>16</td><td>17</td></tr> <tr><td>18</td><td>19</td><td>20</td><td>21</td><td>22</td><td>23</td><td>24</td></tr> <tr><td>25</td><td>26</td><td>27</td><td>28</td><td>29</td><td>30</td><td>31</td></tr> </table>	S	M	T	W	T	F	S					1	2	3	4	5	6	7	8	9	10	11	12	13	14	15	16	17	18	19	20	21	22	23	24	25	26	27	28	29	30	31	<p><u>2, 5-9</u>—No School</p> <p><u>23</u>—No School/Teacher Workday</p>	<p>APRIL 2021</p> <table> <tr><th>S</th><th>M</th><th>T</th><th>W</th><th>T</th><th>F</th><th>S</th></tr> <tr><td></td><td></td><td></td><td></td><td>1</td><td>2</td><td>3</td></tr> <tr><td>4</td><td>5</td><td>6</td><td>7</td><td>8</td><td>9</td><td>10</td></tr> <tr><td>11</td><td>12</td><td>13</td><td>14</td><td>15</td><td>16</td><td>17</td></tr> <tr><td>18</td><td>19</td><td>20</td><td>21</td><td>22</td><td>23</td><td>24</td></tr> <tr><td>25</td><td>26</td><td>27</td><td>28</td><td>29</td><td>30</td><td></td></tr> </table>	S	M	T	W	T	F	S					1	2	3	4	5	6	7	8	9	10	11	12	13	14	15	16	17	18	19	20	21	22	23	24	25	26	27	28	29	30								
S	M	T	W	T	F	S																																																																																								
				1	2	3																																																																																								
4	5	6	7	8	9	10																																																																																								
11	12	13	14	15	16	17																																																																																								
18	19	20	21	22	23	24																																																																																								
25	26	27	28	29	30	31																																																																																								
S	M	T	W	T	F	S																																																																																								
				1	2	3																																																																																								
4	5	6	7	8	9	10																																																																																								
11	12	13	14	15	16	17																																																																																								
18	19	20	21	22	23	24																																																																																								
25	26	27	28	29	30																																																																																									
<p><u>2</u>—No School/Teacher Workday</p> <p><u>3</u>—No School</p> <p><u>24</u>—Q2 Interim Report</p> <p><u>25-27</u>—No School</p>	<p>NOVEMBER 2020</p> <table> <tr><th>S</th><th>M</th><th>T</th><th>W</th><th>T</th><th>F</th><th>S</th></tr> <tr><td>1</td><td>2</td><td>3</td><td>4</td><td>5</td><td>6</td><td>7</td></tr> <tr><td>8</td><td>9</td><td>10</td><td>11</td><td>12</td><td>13</td><td>14</td></tr> <tr><td>15</td><td>16</td><td>17</td><td>18</td><td>19</td><td>20</td><td>21</td></tr> <tr><td>22</td><td>23</td><td>24</td><td>25</td><td>26</td><td>27</td><td>28</td></tr> <tr><td>29</td><td>30</td><td></td><td></td><td></td><td></td><td></td></tr> </table>	S	M	T	W	T	F	S	1	2	3	4	5	6	7	8	9	10	11	12	13	14	15	16	17	18	19	20	21	22	23	24	25	26	27	28	29	30						<p><u>3</u>—Q4 Interim Report</p> <p><u>31</u>—No School</p>	<p>MAY 2021</p> <table> <tr><th>S</th><th>M</th><th>T</th><th>W</th><th>T</th><th>F</th><th>S</th></tr> <tr><td></td><td></td><td></td><td></td><td></td><td></td><td>1</td></tr> <tr><td>2</td><td>3</td><td>4</td><td>5</td><td>6</td><td>7</td><td>8</td></tr> <tr><td>9</td><td>10</td><td>11</td><td>12</td><td>13</td><td>14</td><td>15</td></tr> <tr><td>16</td><td>17</td><td>18</td><td>19</td><td>20</td><td>21</td><td>22</td></tr> <tr><td>23</td><td>24</td><td>25</td><td>26</td><td>27</td><td>28</td><td>29</td></tr> <tr><td>30</td><td>31</td><td></td><td></td><td></td><td></td><td></td></tr> </table>	S	M	T	W	T	F	S							1	2	3	4	5	6	7	8	9	10	11	12	13	14	15	16	17	18	19	20	21	22	23	24	25	26	27	28	29	30	31					
S	M	T	W	T	F	S																																																																																								
1	2	3	4	5	6	7																																																																																								
8	9	10	11	12	13	14																																																																																								
15	16	17	18	19	20	21																																																																																								
22	23	24	25	26	27	28																																																																																								
29	30																																																																																													
S	M	T	W	T	F	S																																																																																								
						1																																																																																								
2	3	4	5	6	7	8																																																																																								
9	10	11	12	13	14	15																																																																																								
16	17	18	19	20	21	22																																																																																								
23	24	25	26	27	28	29																																																																																								
30	31																																																																																													
<p><u>18</u>—12:00 dismissal</p> <p><u>21-25, 28-31</u>—No School</p>	<p>DECEMBER 2020</p> <table> <tr><th>S</th><th>M</th><th>T</th><th>W</th><th>T</th><th>F</th><th>S</th></tr> <tr><td></td><td></td><td>1</td><td>2</td><td>3</td><td>4</td><td>5</td></tr> <tr><td>6</td><td>7</td><td>8</td><td>9</td><td>10</td><td>11</td><td>12</td></tr> <tr><td>13</td><td>14</td><td>15</td><td>16</td><td>17</td><td>18</td><td>19</td></tr> <tr><td>20</td><td>21</td><td>22</td><td>23</td><td>24</td><td>25</td><td>26</td></tr> <tr><td>27</td><td>28</td><td>29</td><td>30</td><td>31</td><td></td><td></td></tr> </table>	S	M	T	W	T	F	S			1	2	3	4	5	6	7	8	9	10	11	12	13	14	15	16	17	18	19	20	21	22	23	24	25	26	27	28	29	30	31			<p><u>3</u>—12:00 dismissal</p> <p><u>3</u>—12:00 dismissal: Last Day of School</p> <p><u>7-11</u>—Teacher Workdays</p>	<p>JUNE 2021</p> <table> <tr><th>S</th><th>M</th><th>T</th><th>W</th><th>T</th><th>F</th><th>S</th></tr> <tr><td></td><td></td><td>1</td><td>2</td><td>3</td><td>4</td><td>5</td></tr> <tr><td>6</td><td>7</td><td>8</td><td>9</td><td>10</td><td>11</td><td>12</td></tr> <tr><td>13</td><td>14</td><td>15</td><td>16</td><td>17</td><td>18</td><td>19</td></tr> <tr><td>20</td><td>21</td><td>22</td><td>23</td><td>24</td><td>25</td><td>26</td></tr> <tr><td>27</td><td>28</td><td>29</td><td>30</td><td></td><td></td><td></td></tr> </table>	S	M	T	W	T	F	S			1	2	3	4	5	6	7	8	9	10	11	12	13	14	15	16	17	18	19	20	21	22	23	24	25	26	27	28	29	30										
S	M	T	W	T	F	S																																																																																								
		1	2	3	4	5																																																																																								
6	7	8	9	10	11	12																																																																																								
13	14	15	16	17	18	19																																																																																								
20	21	22	23	24	25	26																																																																																								
27	28	29	30	31																																																																																										
S	M	T	W	T	F	S																																																																																								
		1	2	3	4	5																																																																																								
6	7	8	9	10	11	12																																																																																								
13	14	15	16	17	18	19																																																																																								
20	21	22	23	24	25	26																																																																																								
27	28	29	30																																																																																											
<p><u>1</u>—No School</p> <p><u>14</u>—Q2 Ends</p> <p><u>15</u>—No School/Teacher Workday</p> <p><u>18</u>—No School</p> <p><u>21</u>—Q2 Report Card Sent Home</p>	<p>JANUARY 2021</p> <table> <tr><th>S</th><th>M</th><th>T</th><th>W</th><th>T</th><th>F</th><th>S</th></tr> <tr><td></td><td></td><td></td><td></td><td></td><td>1</td><td>2</td></tr> <tr><td>3</td><td>4</td><td>5</td><td>6</td><td>7</td><td>8</td><td>9</td></tr> <tr><td>10</td><td>11</td><td>12</td><td>13</td><td>14</td><td>15</td><td>16</td></tr> <tr><td>17</td><td>18</td><td>19</td><td>20</td><td>21</td><td>22</td><td>23</td></tr> <tr><td>24</td><td>25</td><td>26</td><td>27</td><td>28</td><td>29</td><td>30</td></tr> <tr><td>31</td><td></td><td></td><td></td><td></td><td></td><td></td></tr> </table>	S	M	T	W	T	F	S						1	2	3	4	5	6	7	8	9	10	11	12	13	14	15	16	17	18	19	20	21	22	23	24	25	26	27	28	29	30	31							<p>Notes</p> <p>If there is not improvement, we would move to virtual learning from November 30 to January 15, at which point we would hope to return to in-person on January 19.</p> <p>revised 7/13/20</p>																																											
S	M	T	W	T	F	S																																																																																								
					1	2																																																																																								
3	4	5	6	7	8	9																																																																																								
10	11	12	13	14	15	16																																																																																								
17	18	19	20	21	22	23																																																																																								
24	25	26	27	28	29	30																																																																																								
31																																																																																														

Re-Opening Scenarios

Per DHEC and SCDE guidelines, we will have several reopening plans depending upon whether Pickens County is **high risk**, **medium risk**, or **low risk** (see graph below). We will use Pickens County's risk scale due to Lakes and Bridges Charter School being located in Pickens County. It is recommended that we start the school year in a hybrid model so that relationships can be formed before going to a distance model.

Re-Opening Plans for LABCS

Based on Risks for Pickens County

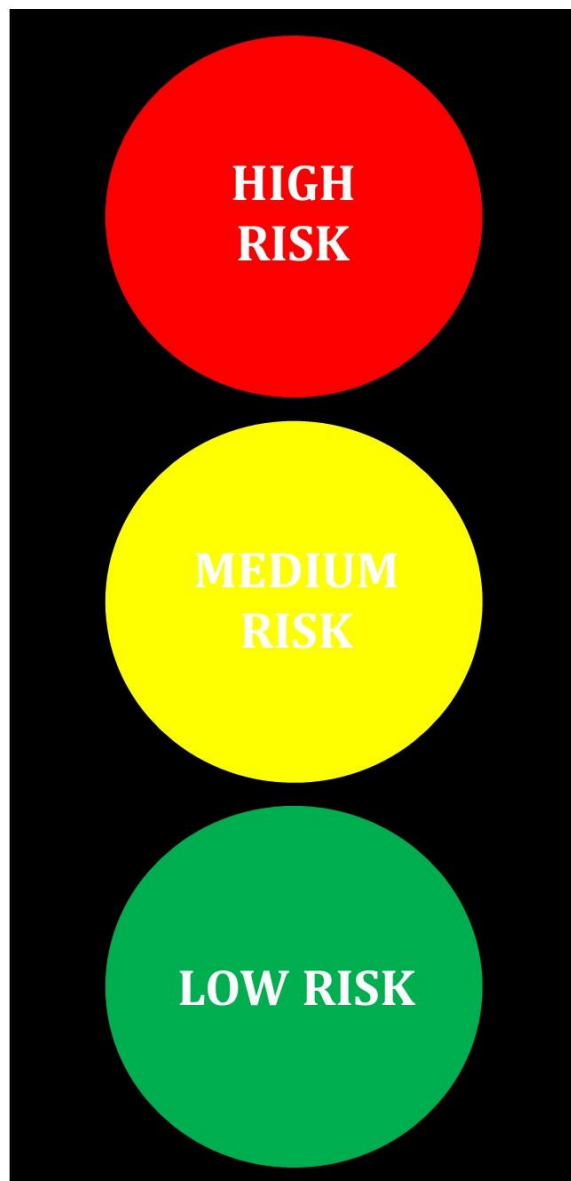

All Distance Learning

All students will do school from home with clear expectations for virtual learning

Hybrid

Students will follow an A/B schedule with 2 days in school at 50% capacity with some restrictions and 3 days virtually with clear expectations for virtual learning (these groups would be determined by carpools).

All In-Person

All students will be in the building at 100% capacity with moderate restrictions.

For the **High-Risk** plan, the school will follow an all-distance learning model. Teachers will teach their subject areas through the utilization of Swivl (<https://www.swivl.com/distance-learning/>) using Google Meet rather than Zoom, which will allow learning to occur in a synchronous (live) situation. If the building is not contaminated, teachers will come into their classrooms and teach using Swivl. Students will be expected to sign on at 8:15 am through Google Meet, the time when school would begin with their homerooms. All assignments will be located in their Google Classroom; in addition, some assignments will be synchronous (meaning simultaneously through Google Meet) and some assignments will be asynchronous (meaning independent work). They will get breaks during their recess, lunch, and PE times. Their Math Standards class will receive instruction through IXL math standards or other asynchronous assignments assigned by their teacher and would be asynchronous. Students will be given daily asynchronous physical activities by their PE teacher in order to stay active, and they will be held accountable for this (to be determined). Attendance will be taken by noting whether or not students sign on into each class and stay on the whole time. Students will not be allowed to come and go in classes as they wish, nor will they be allowed to black out their screens during class without teacher permission. Participation and engagement will have a higher weight value on grades than with previous report cards. Attendance expectations and grading guidelines for distance learning during the times when safety of students and teachers do not allow us to be in the building will mirror the expectations and grading guidelines that are in place when students are in a traditional teaching and learning setting.

For the **Medium-Risk** plan, the school will follow an A/B (Lakes Group, Bridges Group) Hybrid schedule with 50% of the students attending on Monday/Tuesday (Lakes Group), and the other 50% of the students attending on Thursday/Friday (Bridges Group). Preference for grouping will be based upon several factors to include carpool preference and/or county location. While Lakes Group is in the building learning in person, Bridges Group will be home signed into their computer learning simultaneously through Google Meet. Students at school and at home will follow the same schedule. Technology expectations for students and parents will be the same for a distance learning model (for both students who will have to do distance learning during the year or for those who opt to do the 100% Virtual Learning model) or a hybrid model. The distance learning classes for both the **High-Risk** and **Medium-Risk** models will remain the same so that students have several breaks during the day from being in front of the computer all day (see **High-Risk** information). 100% Virtual Learning and Distance Learning students will stay signed in during the entire class and will not be allowed to black out their screens, unless the teacher gives permission, for their PIE, Math-U-See, ELA Reading, and ELA Writing. Social Studies/Science will be a combination of synchronous (live) and asynchronous (independent work). See the schedules below for signing on by grade/homeroom. Expectations and grading guidelines for distance learning in this hybrid model will mirror the attendance expectations and

grading guidelines that are in place when students are in a traditional teaching and learning setting. At this time, masks and/or face shields will be mandatory for the faculty/staff, especially if they are working with students within a 6' radius. Students will also be required to wear facial coverings and can remove them once they are seated at their desk in their homeroom. At this time they can take off their mask. Additionally, all faculty/staff and students will be required to wear masks during transition times (arrival to school, hallways, dismissal) and at any time in the building that they cannot physically distance.

All student desks will face forward maintaining a 6' distance or current recommendations for distancing in the classroom. All extraneous furniture will be removed from classrooms in order to maximize the space. Students will remain as a cohort in their classroom throughout the day with teachers coming in and out of the classroom. They will also eat lunch in their classroom. The only time students will transition out of their classroom is to go to PE, PIE, the restroom, scheduled handwashing breaks, and end-of-day dismissal.

Wednesdays in all models, to include 100% Virtual Learning, will be spent with *The Leader in Me*, *Olweus Bullying Prevention*, and/or Homeroom activities, as well as a day for teachers to work individually with students via Google Meet or in person, if conditions allow.

For the **Low-Risk** plan, students will be in the school as normal with some restrictions (possible use of face masks, physical distancing, etc.).

In the case that 100% capacity face-to-face instruction is required/mandated in **High-Risk** or **Medium-Risk** situations, then every person in the building, to include students, will be required to wear facial coverings at all times, including sitting at their desk, since 6' physical distance, most likely, will not be able to occur.

100% Virtual Learning

Parents will be given the choice to have their child(ren) participate in 100% Virtual Learning. Additional details will be provided at a later date, but please note descriptions for virtual learning in the **High-Risk** and **Medium-Risk** Plans. Those who commit to 100% Virtual Learning will have the option to return to in-person learning at the end of the first semester (end of the 2nd quarter) if the numbers allow for physical distancing in the classroom. Attendance expectations and grading guidelines for 100% Virtual Learning will mirror the attendance expectations and grading guidelines that are in place when students are in a traditional teaching and learning setting. According to the state mandate, students 18 or under are required to be in school. Students who do not sign on and who do not complete assignments will be

considered non-compliant and will face consequences that could range from failing grades to reported truancy to being required to change the instructional setting and more.

Class Schedules for 100% Virtual Learning and Distance/Hybrid Learning (Times to Sign On)

Schedules for the following grades will be as follows, and students in the grades below will be required to be online through Google Meet at the times noted.

1st Grade

8:15-8:30 - HR

8:30-9:15 - ELA Writing

9:20-10:05 - PIE

10:10-10:55 - Math-U-See

12:40-1:25 - ELA Reading

2:20-3:05* - Social Studies/Science

**some of the assignments at this time will be assigned through independent projects/videos/similar*

2nd Grade

8:15-8:30 - HR

8:30-9:15 - ELA Reading

9:20-10:05 - PIE

10:10-10:55 - Math-U-See

12:40-1:25 - ELA Writing

2:20-3:05* - Social Studies/Science

**some of the assignments at this time will be assigned through independent projects/videos/similar*

3rd Grade

8:15-8:30 - HR

8:30-9:15 - ELA Reading

9:20-10:05 - PIE

10:10-10:55 - Math-U-See

12:40-1:25* - Social Studies/Science

1:30-2:15 - ELA Writing

**some of the assignments at this time will be assigned through independent projects/videos/similar*

4th Grade (Ms. Maggie's class - the roster will be sent at a later date)

8:15-8:30 - HR

8:30-9:15 - ELA Reading

9:20-10:05 - Math-U-See

10:10-10:55 - ELA Writing

11:50-12:35 - PIE

12:40-1:25* - Social Studies/Science

**some of the assignments at this time will be assigned through independent projects/videos/similar*

4th Grade (Mrs. Stoker's class - the roster will be sent at a later date)

8:15-8:30 - HR

8:30-9:15 - ELA Writing

9:20-10:05 - ELA Reading

10:10-10:55 - Math-U-See

11:50-12:35 - PIE

1:30-2:15* - Social Studies/Science

**some of the assignments at this time will be assigned through independent projects/videos/similar*

5th Grade (Mrs. Rivers's Homeroom class - the roster will be sent at a later date)

8:15-8:30 - HR

8:30-9:15 - Math-U-See

9:20-10:05* - Social Studies/Science

10:10-10:55 - PIE

11:00-11:45 - ELA Writing

12:40-1:25 - ELA Reading

**some of the assignments at this time will be assigned through independent projects/videos/similar*

5th Grade (Ms. Simmons's Homeroom class - the roster will be sent at a later date)

8:15-8:30 - HR

8:30-9:15 - ELA Writing

9:20-10:05* - Social Studies/Science

10:10-10:55 - PIE

1:30-2:15 - ELA Reading

2:20-3:05 - Math-U-See

**some of the assignments at this time will be assigned through independent projects/videos/similar*

6th Grade (Ms. Compton's Homeroom class - the roster will be sent at a later date)

8:15-8:30 - HR

9:20-10:05 - ELA Reading

11:00-11:45 - PIE

12:40-1:25 - Math-U-See

1:30-2:15* - Social Studies/Science

2:20-3:05 - ELA Writing

**some of the assignments at this time will be assigned through independent projects/videos/similar*

7th Grade (Mrs. Tucker's Homeroom class - the roster will be sent at a later date)

8:15-8:30 - HR

8:30-9:15 - PIE

9:20-10:05 - ELA Writing

10:10-10:55 - ELA Reading

12:40-1:25* - Social Studies/Science

1:30-2:15 - Math-U-See

**some of the assignments at this time will be assigned through independent projects/videos/similar*

7th Grade (Mr. Duran's Homeroom class - the roster will be sent at a later date)

8:15-8:30 - HR

8:30-9:15 - PIE

11:00-11:45 - ELA Reading

12:40-1:25 - Math-U-See

1:30-2:15 - ELA Writing

2:20-3:05* - Social Studies/Science

**some of the assignments at this time will be assigned through independent projects/videos/similar*

Arrival and Dismissal at School

Arrival

Early Stay will be available for students who are attending in person from 7:15-7:45 for a fee of \$5/day. Students will be physically distanced in the front lobby.

Students not participating in Early Stay will begin arriving at 7:45 am. To minimize the number of students in any part of the building, students will enter at designated entrances by grade (see map).

- Students in grades 1-3 will be dropped off at the front entrance even if they are in a carpool.
- Students in grades 4-5 will be dropped off at the flagpole even if they are in a carpool.
- Students in grades 6-7 will be dropped off at the Dragon's Den entrance (former drop off and pick up entrance) even if they are in a carpool.
- Teachers and staff will ensure that all students will arrive safely to their homeroom classes.

Dismissal

All students will be picked up at the Dragon's Den side of the building (Frank Parrott Road side) lining up by letter and number on the cones and yellow columns. Students will remain in their homeroom

classes until their name is called as parents/carpools arrive. Students will be required to wear facial coverings during this transition from the classroom to the car line. A larger map can be found [here](#).

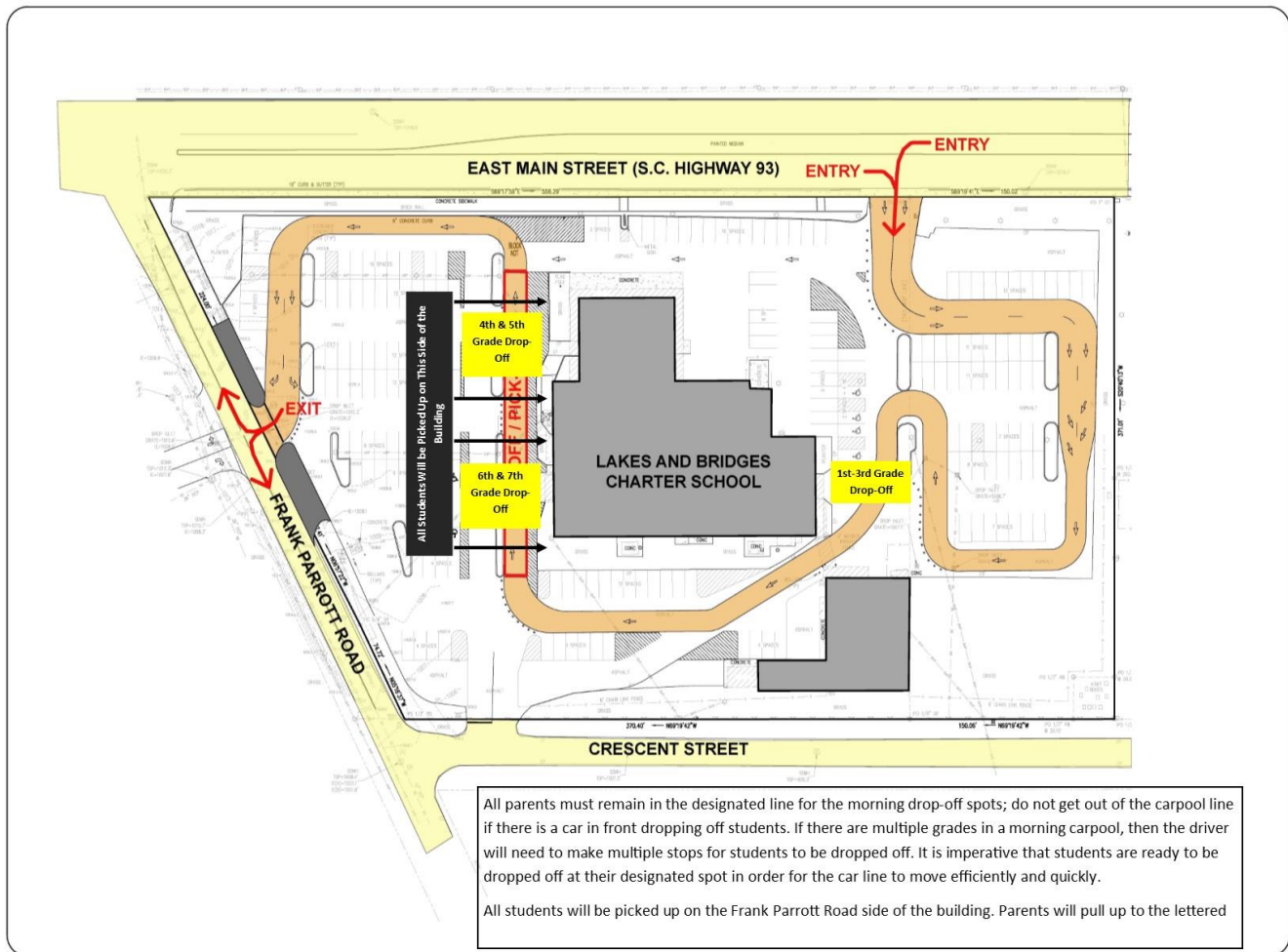

Benchmark and Other Assessments

With our continued focus on small group instruction, students will take benchmark assessments at the beginning of the 2020-2021 school year. This gives us baseline data in order to make the best instructional decisions for students' success. We will try to bring students in during the week of August 10 in order to do baseline benchmarking so that we can begin looking at groups for PIE and Math-U-See classes. Our goal is to place students in the best learning environment in order for them to be successful.

Classrooms

All student desks will face forward maintaining a 6' distance or current recommendations for distancing in the classroom. All extraneous furniture will be removed from classrooms in order to maximize the space. Students will remain as a cohort in their classroom throughout the day with teachers coming in and out of the classroom. All classrooms will have wall-mounted hand sanitizer stations, as well as hand-mounted sanitizer dispensers throughout the school building.

Classroom Supplies

The supply fee has been reduced from \$75 to \$50, and parents will be given a supply list to purchase particular items for their individual child's use in the classroom. These supplies will be kept in specified areas in the classroom during the school day, and students will not be sharing supplies, nor transporting supplies to and from school and home. The supply list can be found [here](#).

Cleaning and Safety Plan

The school will be deep cleaned twice a week (mid-week and end of week), as well as sanitized every day and multiple times during the day. There will be wall-mounted hand sanitizer stations in every classroom, as well as throughout the school. Teachers and the cleaning staff will be cleaning and disinfecting throughout the day. All supplies used for cleaning, sanitizing, and deep cleaning will follow CDC and DHEC guidelines

During this time, there will be no visitors or guests allowed in the building. If a student needs to be dropped off late (after 8:15 am) or picked up before the regularly scheduled dismissal time of 3:30 pm, the parent needs to call the front office (864-442-5580) so that the student can be let into the building and/or the student can be walked to the front door to be picked up.

All the HVAC in the building have ionizers already installed, as well as fresh air circulating in classrooms.

Dress Code

The dress code for the 2020-2021 school year will be relaxed and be uniform optional. Please look for further information on the dress code to come out.

Facial Coverings

At this time, all faculty/staff and students will be required to wear facial coverings at all times during transition times (drop-off, pick-up, hallways, etc.) when a 6' physical distance cannot be maintained. Students may take their masks off when they are seated at their desk.

All students will be given a school-issued lanyard onto which they can clip their face mask so that masks are not lost.

In the case that 100% capacity face-to-face instruction is required/mandated in **High-Risk** or **Medium-Risk** situations, then every person in the building, to include students, will be required to wear facial coverings at all times, including sitting at their desk, since 6' physical distance, most likely, will not be able to occur.

Health Information

We will follow DHEC guidance on necessary measures to keep our students and staff healthy (please note that DHEC guidance is fluid and changing – we will keep the school community apprised of changes as they occur). It is of paramount importance that the parents and the school work together to make this year a success. Parents should do a health screening on their child daily before sending to school. LABCS will follow DHEC's recommendations for isolation/quarantine.

Students/staff will be excluded from school with one of the following:

- fever
- shortness of breath
- worsening cough, or
- loss of taste or smell;

or any two of the following:

- sore throat
- muscle/body aches, chills
- nausea or vomiting
- diarrhea
- fatigue
- headache or congestion/runny nose.

Also, if a student or staff is a close contact to a person with a positive case of Covid-19, they will need to be excluded from the school building until their quarantine period is over.

If a student or teacher within a classroom tests positive for COVID-19, other students/teachers will be notified and asked to quarantine for 14 days and be tested 7 days after their last contact with the positive case. As soon as the school gets the notice, LABCS will notify all the class and close contacts via our Bloomz or school email notifications (student or teacher names will not be released to maintain confidentiality with HIPAA and FERPA). The whole class and will switch to distant learning during this time. The quarantine period will be necessary for siblings as well as any close contacts in a carpool situation as well.

PCR testing (nose or throat swab) is the testing method to identify positive cases.

Before returning to school, the person with a positive case will need to complete 10 days after the beginning of symptoms, AND 24 hours fever free (without fever reducing medications), AND overall improvement in symptoms. Those who were in close contact with a positive case, will need to complete the 14 days quarantine without any symptoms. If symptoms develop, the above criteria would apply (10 days after symptoms begin, 24 hr. fever free, and overall improvement) before returning to the school building.

If a student develops these symptoms while at school, the student will be required to wear a mask, and the teacher, support teacher, principal, or a member of the leadership team will escort the student to the isolation room and notify the nurse. The nurse will call the parent to come and pick up the student.

The nurse will keep DHEC, LABCS administration, the LABCS board, and the SCPCSD up to date on the school's health status for as long as needed.

Lunch

Students will eat lunch in their classrooms. If students purchase lunch from our provider (we anticipate using the SDPC again this year), the lunches will be delivered to the classrooms by faculty or staff. Unfortunately, no parents or visitors will be allowed, at this time, to come into the building to eat lunch with their child(ren). Please practice with your child to independently open items in their lunches from home in order to minimize contact from others opening it for them. A benefit to this is that the more efficient they are with being able to open these items independently, the more time they will have to eat their lunch.

Perfect Attendance

We will not be recognizing perfect attendance this year in an effort to make sure that students who are sick stay home.

Physical Distancing

In order to reduce the frequency of close contact between individuals, physical distancing (aka known as social distancing) is still, according to guidelines and recommendations, one of the most effective ways to slow the spread of COVID-19. Children and adults are to stay 6' apart (there will be stickers in the hallway and classroom floors). Hallways will be marked with one-way indicators (painted, stenciled dragon's footprints). Spaces utilized by children will be limited. In the event physical distancing cannot be maintained, faculty/staff and students will be required to wear facial coverings.

PE (Physical Education)

PE on campus will consist of physical activity that does not involve direct contact or immediate closeness of students with each other or with the teachers. Activities will be appropriate for physical distancing. For students participating in virtual learning and/or if conditions warrant for the whole school to be out with virtual learning, students will be given daily PE activities to complete, and a PE log will be kept. More information will be provided at a later date.

Recess

Students will be required wear facial coverings when transitioning to and from recess and can be removed once outside or in their classroom. Activities that promote physical distancing will occur. No touch or contact activities will be allowed. More information will be provided at a later date.

Safety Drills

In the event of safety drills (fire, tornado, lock-down, etc.) where physical distance cannot be maintained, faculty/staff and students will be required to wear a facial covering.

Social/Emotional Learning

As we return to school during the COVID-19 pandemic, recognizing and addressing social and emotional stress in our students is paramount to their ability to engage in classroom learning (virtual or in person). We know that all families have been affected by this pandemic, but that some families may have experienced trauma specific to COVID-19. In response to any trauma experienced by our students, our Student Wellness Facilitator (Mrs. Stephanie Phifer, sphifer@labcharterschool.org) is planning to administer a screener to our students and parents to identify those students that have experienced adversity or need assistance with coping during this time. Once data has been collected and analyzed, the Student Wellness Facilitator will meet with students for classroom lessons, group meetings, and/or individual meetings. There will be a focus on learning strategies for self-regulation, relationship building, and grief counseling; all using a multi-sensory approach. The Student Wellness Facilitator will work closely with teachers and families to help identify students who are experiencing difficulties as we transition into the new school year.

Special Education and Other Services

Regardless of which type of learning is involved, students with disabilities will receive support to access and process the curricular content to maximize their learning. We understand the needs of our exceptional students within our special population; Gifted and talented, English Language Learners, Students needing Multi-tiered Systems of Support, Students with a 504, and students with an Individualized Education Plan. We intend to provide each of our students with a quality classroom and online environment. We are also committed to the Orton Gillingham Approach. The Universal Design of Learning will guide us in keeping our students engaged in what, how, and why they are learning.

Technology Expectations

All students will be issued and required to participate in school learning using a school device.

- 1st-3rd grade students will have iPads and 4th-7th grade students will have Chromebooks.
- Students and parents will receive information and assistance regarding usage of these devices.

These devices will be in protective cases or covers and must remain in the covers at all times to maintain the safety of the devices. Per the technology handbook, devices will not be left outside or in a hot vehicle. They cannot be left on the floor or in a place where they could be damaged. Accidents do

happen, but we have a limited number of devices and need each student to be diligent in the safety and protection of their issued device.

Students will be issued their Google **username and password** at the beginning of school and will log in to their devices with that information. We have a new security filter in place for the 2020-2021 school year that runs off of those accounts. Devices will not be tampered with or jailbroken to by-pass the domain logins on the devices.

Our LMS (Learning Management System) this school year is Google Classroom. We are a Google school and all Google apps will be utilized daily. Every class/grade will have a Classroom where students will be able to access lessons, videos, help links, and more throughout the year (more information and tutorials to come). While we have Bloomz for social check-in and communication, all academic communications will occur in Classroom.

Students must have access to the internet in the home that is strong enough to support a learning device with online instruction. If this provision is not possible or becomes difficult, please contact the Technology Director, (Mrs. Marie Moon, mmoon@labcharterschool.org) or a Help Desk ticket) to discuss available options for assistance.

There will be a folder with help videos available for parents and students regarding the various software and hardware provided. We also have a Help Desk system this year to allow quick response time for technical support.

For those families who choose to participate in 100% Virtual Learning, a more detailed plan with expectations will be provided at a later date.

Another plan will be sent to parents who choose in-person learning that details expectations for those times that we will be required to do distance learning.

All parents will be required to pay a \$25 technology fee/child.

Water Bottles

Water fountains in the building will be turned off for health and safety reasons. As a result, students will not be able to refill their bottles at school. Please plan to send in an additional filled water bottle if needed. Just a reminder that students are only allowed to have water in their bottle.